

EXTERIOR LOAD BEARING WALL CHANGE FORM - LBW(E) ©

HOW TO USE THIS FORM: On a PC, complete this form by using the drop down menus or by typing in your own answers. On a mobile device, download and then open with Adobe Reader or PDF Reader, etc. Then save the PDF file with your name added at the end and email it. You can also print this form and then clearly write answers to each question 1 - 12, then email a scan or photograph of this form. Use one form for each opening. We'll review and contact you if we need more details before providing our fee for an engineer sealed/signed solution. If the information is not adequate, we can discuss a site visit. No fees, work, or visits will happen without your agreement. Need help? Call us at 713-377-4209 (Houston open 9-5 M-F). Eco-Holdings LLC is a Registered and Insured Texas Engineering Firm (F-7395).

select, type, or write

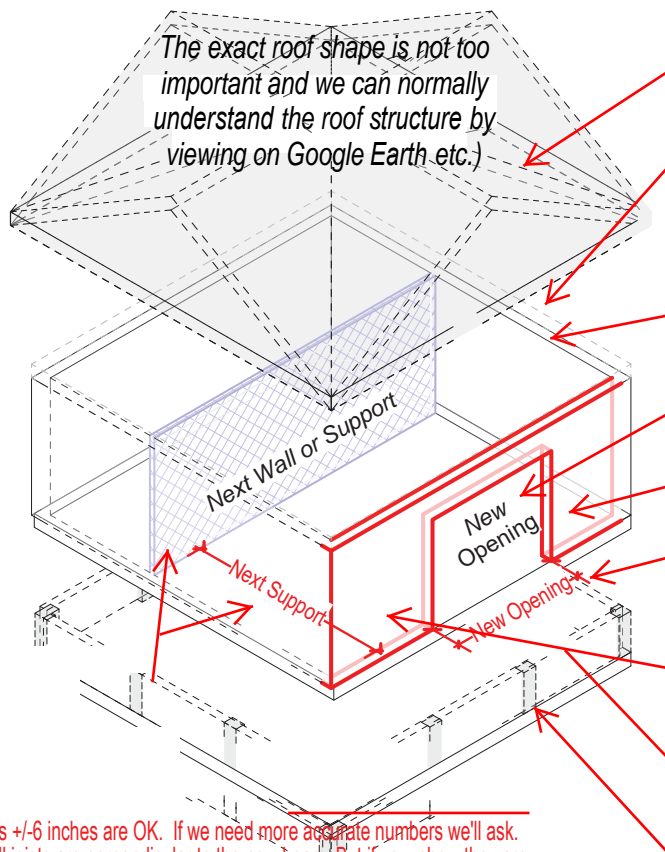

Measurements +/-6 inches are OK. If we need more accurate numbers we'll ask. We assume all joists are perpendicular to the new beam. But if you show they are not, the new beam might be smaller. Also tell us if a balcony is on the outside!

This foundation is shown 'floating' below the house, but it might be a slab underneath. Normally we define the type using Google Maps.

We can normally tell the number of stories by ~~viewing on Google Maps~~

(No dashes, Numbers only)

Name:

Ph#

Add#:

+ Street Name

ZIP

Email:

Button for PCs Only

Done? Save & Email to "LoadBearing@texasengineer.com". If on a PC try the Auto Email button--->

<< Copyright © 2019 Eco-Holdings LLC Engineering Services (F-7395) 4010 Blue Bonnet Blvd., Houston, Texas 77025 >>

HOW IT WORKS: Once received we can review and provide our fee. If you agree we'll begin to select the best beam and the correct supports to safely carry all loads created by your new or enlarged opening into your structure & foundation. If needed we can explain how we define walls as load bearing or not load bearing (most are load bearing). We can also explain if your opening needs a flush beam or a dropped beam and if it needs to be an engineered wood beam (Glulam, LVL, PSL, etc.) or multiple dimensional lumber members that are properly connected. We will include instructions for making safe load bearing changes.

WHAT ELSE: Be sure to provide your project's complete physical address with ZIP code with your best email and phone (mobile preferred). Send phone or other digital photos taken of the whole wall from as far back as possible from each side. Also take photos of the room(s) above showing the flooring (carpet, hardwood, laminate, or tile) and don't forget to include attached balconies. Try to mark the opening on a photo. This form plus your photos works as good as a visit for almost all projects, but if needed we can discuss a site trip for additional field verification.